

Phonak Virto B-Titanium

(B90/B70)

User Guide



A Sonova brand

PHONAK
life is on

Your hearing aid details

This user guide is valid for:

Non wireless models	CE mark applied
Phonak Virto B90-Titanium	2016
Phonak Virto B70-Titanium	2016

Model	Battery size
Phonak Virto B-Titanium	10

Your hearing care professional:

┌

└

┌

└



Your hearing aids have been developed by Phonak – the world leader in hearing solutions based in Zurich, Switzerland.

These premium products are the result of decades of research and expertise and are designed to keep you connected to the beauty of sound! We thank you for making such a great choice and wish you many years of listening pleasure.

Please read the user guide carefully to make sure that you understand and get the best out of your hearing aids. For more information about features and benefits, simply contact your hearing care professional.

Phonak – life is on
www.phonak.com

Contents

Your hearing aid	
1. Quick guide	6
2. Parts of the hearing aid	8
Using the hearing aid	
3. Left & right hearing aid markings	9
4. On/Off	10
5. Battery	11
6. Putting on the hearing aid	13
7. Removing the hearing aid	14
8. Push button	15
9. Adjusting the hearing aid with Phonak MiniControl	16
Further Information	
10. Care and maintenance	18
11. Service and warranty	20
12. Compliance information	22
13. Information and description of symbols	23
14. Troubleshooting	28
15. Important safety information	30

1. Quick guide

Left & right hearing aid markings



Left



Right

Blue marking for **left** hearing aid.

Red marking for **right** hearing aid.

Changing batteries

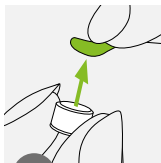

1

Remove the sticker from the battery door and wait two minutes.

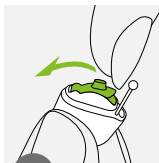

2

Open the battery door.

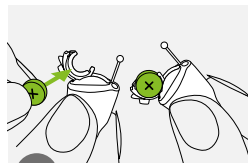

3

Place battery in the battery door with the "+" symbol facing upwards.

On/Off

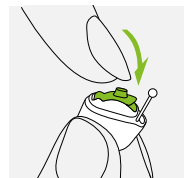

On

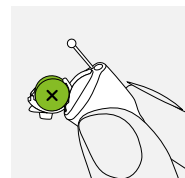

Off

Push button

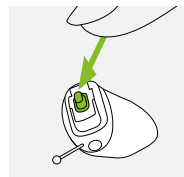

Models with this option only:
The push button on your hearing aid can have various functions.

2. Parts of the hearing aid

The picture below shows the model described in this user guide.

Virto B-Titanium

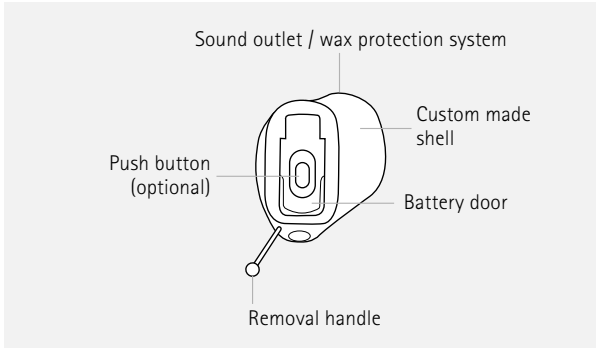

3. Left & right hearing aid markings

There is a red or blue inlay in the battery door to tell you if it is a left or a right hearing aid.

Blue marking for **left** hearing aid.

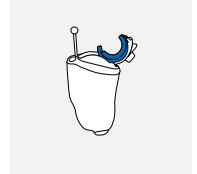

Red marking for **right** hearing aid.

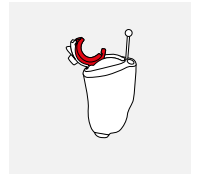

4. On/Off

The battery door is also the on/off switch.

1
Closed battery door =
hearing aid is **on**

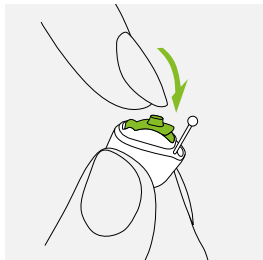

2
Opened battery door =
hearing aid is **off**

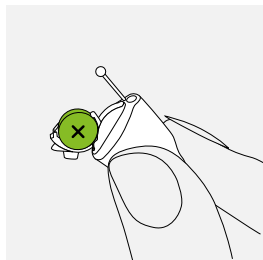

i When you switch on the hearing aid you may hear a start-up melody.

5. Battery

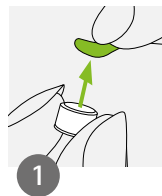

1
Remove the
sticker from the
new battery
and wait two
minutes.

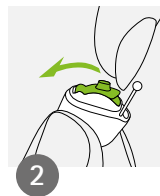

2
Open the
battery door.

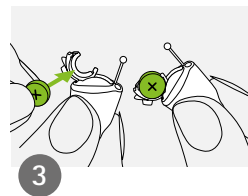

3
Place battery in the
battery door with the
"+" symbol facing
upwards.

i If it is difficult to close the battery door: Check that the battery is inserted correctly and the "+" symbol is facing upwards. If the battery is not inserted correctly, the hearing aid will not work and the battery door can be damaged.

📱 Low power: You will hear two beeps when the battery is low. You will have approximately 30 minutes to change the battery (this can vary, depending on the hearing aid settings and battery). We recommend that you always have a new battery on hand.

6. Putting on the hearing aid

Replacement battery

This hearing aid requires zinc-air batteries. Identify the correct battery size (10) by:

- Checking "Your hearing aid details" on page 5.
- Checking the marking on the inner side of the battery door.
- Checking the following table.

Model	Zinc air battery size	Color marking on package	IEC code	ANSI code
Phonak Virto				
B-Titanium	10	yellow	PR70	7005ZD

- i** Please ensure you use the correct type of battery in your hearing aids (zinc-air). Please also read chapter 15.2 for further information on product safety.

Take your hearing aid up to your ear and place the ear canal part into your ear canal.

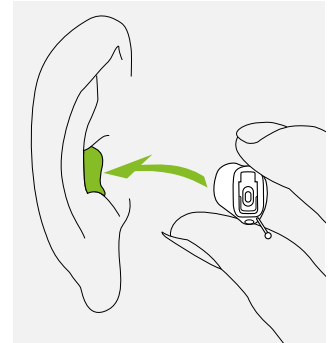

7. Removing the hearing aid

Hold the removal handle and carefully pull the hearing aid up and out of the ear.

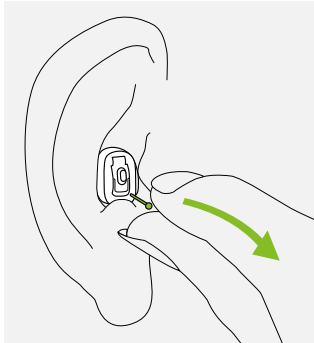

8. Push button

Models with this option only:

The push button on your hearing aid can have various functions or is not active. This depends on the programming of the hearing aid, which is indicated in your individual "Hearing aid instructions". Please ask your hearing care professional for this printout.

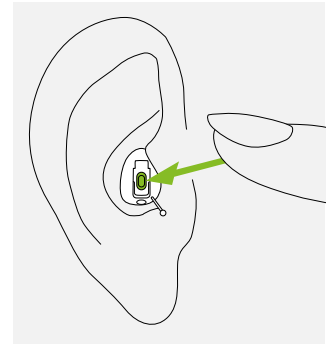

9. Adjusting the hearing aid with Phonak MiniControl

Note: models with this option only.

The MiniControl contains a magnet that functions like a remote control to change the settings of your hearing aid.

Your hearing aid in combination with MiniControl can have various functions or can remain inactive. This depends on your individual settings, which are indicated in your individual "Hearing aid instructions". Please ask your hearing care professional for this print out.

To use the MiniControl, unscrew the magnet from the keychain housing and hold it inside the ear canal without touching the hearing aid.

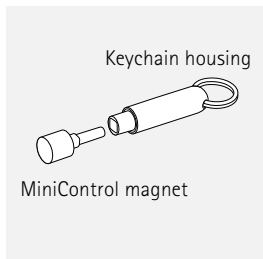

While the hearing aid is on, hold the magnet inside the ear canal without touching the hearing aid.

Promptly remove the magnet as soon as your hearing aid is in the desired program or the volume is ideal for you.

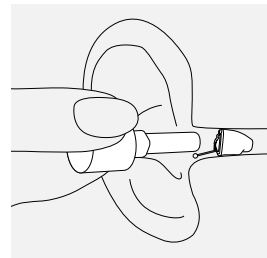

- ⚠️ If you use a medical device like a pacemaker or ICD device (implantable cardioverter defibrillator), please read the specific user guide to clarify possible impact of magnetic fields to your medical device.
- ⚠️ Do not place the MiniControl (neither open nor closed) in your breast pocket. Keep a distance of at least 15 cm (6 inches) between the MiniControl and any medical device.

10. Care and maintenance

Diligent and routine care of your hearing aid contributes to outstanding performance and a long service life.

Please use the following specifications as a guideline. For further information regarding product safety, see chapter 15.2.

General information

Before using hair spray or applying cosmetics, you should remove your hearing aid from your ear, because these products may damage it.

Daily

Daily cleaning and the use of a drying system is highly recommended. C&C line from Phonak is a complete set of cleaning products. Your hearing care professional will be glad to advise you. Never use household cleaning products (washing powder, soap, etc.) to clean your hearing aids.

If your hearing aid is performing weakly or fails to operate, clean or replace the wax guard system. If your hearing aid fails to operate after you have correctly cleaned or replaced your wax protection system and inserted new batteries, contact your hearing care professional for advice.

Weekly

For more in depth maintenance instructions or for more than basic cleaning, please see your hearing care professional.

11. Service and warranty

Local warranty

Please ask the hearing care professional, where you purchased your hearing aid, about the terms of the local warranty.

International warranty

Sonova AG offers a one year limited international warranty, valid starting from the date of purchase. This limited warranty covers manufacturing and material defects in the hearing aid itself, but not accessories such as batteries, tubes, earmolds and external receivers. The warranty only comes into force if a proof of purchase is shown.

The international warranty does not affect any legal rights that you might have under applicable national legislation governing sale of consumer goods.

Warranty limitation

This warranty does not cover damage from improper handling or care, exposure to chemicals or undue stress. Damage caused by third parties or non-authorized service centers renders the warranty null and void. This warranty does not include any services performed by a hearing care professional in their office.

Serial number
(left side):

Authorized hearing care
professional (stamp/signature):

Serial number
(right side):

Date of purchase:

12. Compliance information

Europe:

Declaration of Conformity

Hereby Sonova AG declares that this product meets the requirements of the Medical Devices Directive 93/42/EEC. The full text of the Declaration of Conformity can be obtained from the manufacturer or the local Phonak representative whose address can be taken from the list on www.phonak.com (Phonak worldwide locations).

Australia/New Zealand:



Indicates a device's compliance with applicable Radio Spectrum Management's (RSM) and Australian Communications and Media Authority (ACMA) regulatory arrangements for the legal sale in New Zealand and Australia.

13. Information and description of symbols



With the CE symbol, Sonova AG confirms that this product – including accessories – meets the requirements of the Medical Devices Directive 93/42/EEC. The numbers after the CE symbol correspond to the code of certified institutions that were consulted under the above-mentioned directives.



This symbol indicates that the products described in these user instructions adhere to the requirements for an applied part of Type B of EN 60601-1. The surface of the hearing aid is specified as an applied part of Type B.



Indicates the medical device manufacturer, as defined in EU Directive 93/42/EEC.



During transportation keep dry.



This symbol indicates that it is important for the user to read and take into account the relevant information in these user guides.



This symbol indicates that it is important for the user to pay attention to the relevant warning notices in these user guides.



Important information for handling and product safety.

Operating conditions

The product is designed such that it functions without problems or restrictions if used as intended, unless otherwise noted in these user guides. The hearing aids are classified IP68 (depth of 1 meter for 60 minutes) and designed to be used in all daily life situations. Therefore you do not have to worry about getting the hearing aids exposed to a rain shower or sweat. However, the hearing aid is not intended to be used in water activities that includes chlorinated water, soap, salt water or other liquids with a chemical content.

SN

Indicates the manufacturer's serial number so that a specific medical device can be identified.

REF

Indicates the manufacturer's catalogue number so that the medical device can be identified.



Temperature during transportation and storage: -20° to $+60^{\circ}$ Celsius (-4° to $+140^{\circ}$ Fahrenheit).



Humidity during transportation: Up to 90% (non condensing).
Humidity during storage: 0% to 70%, if not in use. See instruction in chapter 15.2 regarding drying the hearing aid after use.



Atmospheric pressure: 200 hPa to 1500 hPa



The symbol with the crossed-out garbage bin is to make you aware that this hearing aid may not be thrown away as normal household waste. Please dispose of old or unused hearing aids, at waste disposal sites intended for electronic waste, or give your hearing aid to your hearing care professional for disposal. Proper disposal protects the environment and health.

14. Troubleshooting

Problem	Causes
Hearing aid not functioning	Dead battery Blocked sound outlet Battery not inserted correctly Hearing aid switched off
Hearing aid whistles	Hearing aid not inserted correctly Earwax in ear canal
Hearing aid not loud enough or distorted	Volume too loud Low battery Blocked sound outlet Volume too low Physical hearing condition has changed
Hearing aid plays two beeps	Indication for low battery
Hearing aid switches on & off (intermittent)	Moisture on battery or hearing aid

① If the problem persists, contact your hearing care professional for assistance





What to do
Change battery (chapter 1 + 5)
Clean sound outlet
Insert battery correctly (chapter 1 + 5)
Switch hearing aid on by completely closing the battery door (chapter 4)
Insert hearing aid correctly (chapter 6)
Contact your ENT/GP or hearing care professional
Decrease volume if volume control available (chapter 8)
Change battery (chapter 1 + 5)
Clean sound outlet
Turn volume up if volume control available (chapter 8)
Contact your hearing care professional
Change battery within the next 30 minutes (chapter 1 + 5)
Wipe battery and hearing aid with dry cloth

15. Important safety information

Please read the information on the following pages before using your hearing aid.

A hearing aid will not restore normal hearing and will not prevent or improve a hearing impairment resulting from organic conditions. Infrequent use of a hearing aid does not permit a user to attain full benefit from it. The use of a hearing aid is only part of hearing habilitation and may need to be supplemented by auditory training and instruction in lipreading.

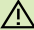
15.1 Hazard warnings

-  The intended use of hearing aids is to amplify and transmit sound to the ears and hereby compensate for impaired hearing. The hearing aids (specially programmed for each hearing loss) must only be used by the intended person. They should not be used by any other person as they could damage hearing.
-  Do not use the hearing aids in explosive areas (mines or industrial areas with danger of explosions, oxygen-rich environments or areas where flammable anesthetics are handled).
-  Hearing aid batteries are toxic if they are swallowed! Keep out of the reach of children, individuals with cognitive impairment, and pets. If batteries are swallowed, consult your physician immediately!
-  Changes or modifications to the hearing aid that were not explicitly approved by Sonova AG are not permitted. Such changes may damage your ear or the hearing aid.

 If you feel pain in or behind your ear, if it is inflamed or if skin irritation and accelerated accumulations of earwax occur, please check with your hearing care professional or physician.

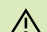
 This hearing aid is not for children below 36 months. It contains small parts that can cause choking, if swallowed by children. Keep out of the reach of children, individuals with cognitive impairment, and pets. If swallowed, consult a physician or hospital immediately.

 Do not make a wire connection from your hearing aid to any external audio sources like radio etc. That could cause injuries on your body (electric shock).

 The following is only applicable for persons with active implantable medical devices (i.e. pacemakers, defibrillators, etc.):

- Keep magnets (i.e. battery handling tool, EasyPhone magnet, etc.) at least 15 cm (6 inches) away from the active implant.
- Please, note that interference can also be caused by power lines, electrostatic discharge, airport metal detectors etc.

 Avoid strong physical impacts to the ear when wearing in-the-ear hearing aids. The stability of in-the-ear shells is designed for normal use. A strong physical impact to the ear (e.g. during sports) may cause the in-the-ear shell to break. This may lead to perforation of the ear canal or ear drum.

15.2 Information on product safety

- ⓘ Never immerse your hearing aid in water! Protect it from excessive moisture. Always remove your hearing aid before showering, bathing, or swimming, as the hearing aid contains sensitive electronic parts.
- ⓘ Protect your hearing aid from heat (never leave near a window or in the car). Never use a microwave or other heating devices to dry your hearing aid. Ask your hearing care professional about suitable drying methods.
- ⓘ When you are not using your hearing aid, leave the battery door open so that any moisture can evaporate. Make sure that you always completely dry your hearing aid after use. Store the hearing aid in a safe, dry and clean place.
- ⓘ Do not drop your hearing aid! Dropping onto a hard surface can damage your hearing aid.
- ⓘ Always use new batteries for your hearing aid. In case a battery is leaking, replace it immediately with a new one to avoid any skin irritation. You can return used batteries to your hearing care professional.
- ⓘ The batteries used in these hearing aids should not exceed 1.5 Volts. Please do not use silver-zinc or Li-ion (lithium-ion) rechargeable batteries as these may cause severe damage to your hearing aids. The table in chapter 5 explains exactly which type of battery your particular hearing aids require.
- ⓘ Remove the battery if you are not using your hearing aid for a long period of time.

① Special medical or dental examination including radiation described below, may adversely affect the correct functioning of your hearing aids. Remove and keep them outside the examination room/area before undergoing:

- Medical or dental examination with X-ray (also CT scan).
- Medical examinations with MRI/NMRI scans, generating magnetic fields.
- Hearing aids don't need to be removed when passing security gates (airports etc.). If X-ray is used at all, it will be in very low doses, and will not affect the hearing aids.

① Do not use your hearing aid in areas where electronic equipment is prohibited.

Your hearing care professional:



029-0480-02/N1.00/2016-11/FO © Sonova AG All rights reserved



Manufacturer:

Sonova AG

Laubisrütistrasse 28

CH-8712 Stäfa

Switzerland

www.phonak.com



sonova
HEAR THE WORLD

